

TECHNICAL DATA

REVERSIBLE VIBRATORY PLATES

BPR 70/70 D, BPR 100/80 D



Maximum longevity

Full protection hood - engine and components protected all around



Safe and dead easy to operate

BOMAG fingertip control



Higher quality, lower costs

ECONOMIZER - The compaction display (optional)

Shipping dimensions in m3

BPR 70/70 D 1,185
BPR 100/80 D 1,376

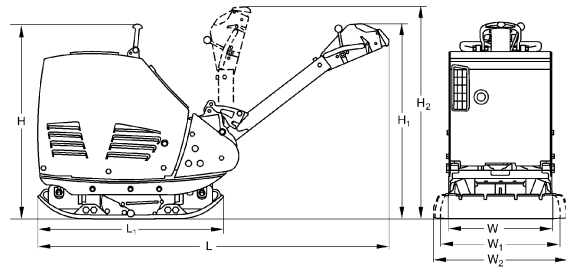

Standard Equipment

- Engine protection hood
- Electric starter
- Tip-Control
- Back-up drive protection
- Low vibration steering rod
- Height adjustable steering rod
- Steering rod lockable in transport and working position
- Vibration and throttle regulation on the steering rod
- Highly wear-resistant, powder-coated base plate
- Automatic shutdown at low oil level
- Multi-functional, foldable single-point lifting facility
- Extension plates (700mm) (BPR70/70D)
- Extension plates (800mm) (BPR100/80D)
- Hour meter
- City mode gas adjustment
- 3-2-1 Warranty

Optional Equipment

- ECONOMIZER (+5kg)
- Tool kit
- Special painting
- Plastic mat
- Extension plates (850mm) (BPR70/70D)
- Extension plates (950mm) (BPR100/80D)
- Service Kit
- Environmentally compliant hydraulic oil
- Safety crank-handle for emergency starting (+3kg)
- US Version EPA 4 NRTC (BPR70/70D:9,2kW)

Dimensions in mm

| | H | H1 | H2 | L | L1 | W | W1 | W2 |
|---------------------|-----|------|------|------|-----|-----|-----|-----|
| BPR 70/70 D | 910 | 1030 | 1470 | 1860 | 980 | 550 | 700 | 850 |
| BPR 100/80 D | 910 | 1180 | 1540 | 1890 | 980 | 650 | 800 | 950 |

Technical Data

Weights

| | | |
|----------------------------|----|-----|
| Operating weight CECE (W) | kg | 557 |
| Operating weight CECE (W1) | kg | 580 |
| Operating weight CECE (W2) | kg | 595 |
| Basic weight | kg | 570 |

Dimensions

| | | |
|---|----|-------|
| Basic working width | mm | 700 |
| Working width w/o extension bars (W) | mm | 550 |
| Lowest passing height | mm | 910 |
| Min. height w. steering in top position | mm | 1.030 |
| Max. height w. steering in top position | mm | 1.180 |

Driving Characteristics

| | | |
|---------------------------------------|-------|----|
| Working speed, max. | m/min | 28 |
| Max. gradeability (dep. on soil con.) | % | 35 |

Drive

| | | |
|--------------------------------------|---------|-----|
| Engine manufacturer | Hatz | |
| Type | 1D 81 | |
| Emission stage | Stage V | |
| Cooling | air | |
| Number of cylinders | 1 | |
| Performance ISO 3046 | 9,3 | |
| Speed | 2.700 | |
| Drive system | mech. | |
| Fuel | Diesel | |
| Fuel comsump. aver. during operation | l/h | 2,0 |

Exciter system

| | | |
|-------------------|----|------|
| Frequency | Hz | 66 |
| Centrifugal force | kN | 70 |
| Amplitude | mm | 1,80 |

Capacities

| | | |
|------|---|------|
| Fuel | l | 10,0 |
|------|---|------|

Technical modifications reserved. Machines may be shown with options.



PRE 692 64 010

240523 Sa04

BOMAG
 Hellerwald
 D-56154 Boppard
 P.O. Box 5162
 Tel. (0)6742 - 1000
 Fax (0)6742 - 3090

